



**Lumina Villa**

**5**  
Bedrooms

**3,657**  
Living Area

**16,243**  
Lot Area





Lumina Villa



# Lumina Villa

AVAILABLE FURNISHED OR UNFURNISHED. ALSO AVAILABLE FOR SALE AT \$5,999,000 - MLS#23-262301 - Mid Century One-Level Hilltop Hideaway with Panoramic Views and Sparkling Pool on a Double Flat Lot. Set in a coveted location just off Mulholland Drive, this Mid-Century masterpiece affords complete seclusion, tucked behind a privacy hedge at the end of a quiet cul-de-sac. Masterfully constructed in 1965 and meticulously remodeled, the hilltop hideaway boasts a double flat lot on over a third acre of lushly landscaped grounds. A serene sanctuary once owned by two silver screen actors, this Hollywood Hills haven affords seamless indoor/outdoor flow and resort-like backyard with saltwater pool and picturesque views of mountains, canyon, and city skyline. Welcomed by a private internal courtyard, guests are ushered towards a meticulously landscaped front stoop dotted in topiaries. Lit by motorized skylights with retractable blinds, a bright, airy foyer flows effortlessly into spectacular, open-concept floorplan. Elevating the everyday with glossy hardwoods and classic post and beam construction, the four-bedroom, four-bathroom abode is a modern marvel, replete with Savant home automation and pre-wired with indoor/outdoor speakers throughout. A contemporary take on the classic Mid-Century home, this 3,657-square foot home unfolds to reveal a sprawling, single-level interior. Walls of glass frame panoramic outdoor vistas from nearly every room in the house. Illuminated by an overhead skylight, the home's spectacular chef's kitchen is poised for dinner parties, replete with custom cabinetry, a Subzero fridge, Wolf range, double Miele dishwasher and Subzero wine fridge. Warmed by an automatic gas fireplace, a recessed living room sets the tone for intimate gatherings, equipped with a soaring beamed ceiling, wide plank hardwoods and original stonework. Luxuriously appointed with a formal dining room and adjacent study, both light soaked gathering spaces spill outward into the lush backyard. Ensconced in mature oak and olive, a flagstone patio with bubbling fountain has been thoughtfully designed with multiple areas for entertaining, including a covered loggia with uninterrupted views. Those sleeping in the primary suite will enjoy a sumptuous sitting area, custom built-ins, walk-in closet, and marble-clad ensuite bath with soaking tub and steam shower. A fully automated smart home outfitted with



Lutron LED recessed lighting, Doorbird video setup, and Hikvision closed circuit cameras, the home affords a dual zone HVAC system, plus cutting-edge Hayward pool/spa equipment and new landscape lighting in the rear. Equipped with ample street parking, this one-of-a-kind property is located mere blocks from the award-winning Wonderland School and renowned Mulholland Tennis Club.

Interior

Total bedrooms	5
Full bathrooms	4

Area & Lot

Living area	3,657sq.ft.
Lot area	16,243sq.ft.
Year built	1965
Neighborhood	West hollywood
Architecture styles	Contemporary
View description	Canyon, city lights, city, trees/woods, skyline, mountains, panoramic, pool, hills, courtyard, tree top

Exterior

Stories	1
Parking	2

Financial

Price upon request	
--------------------	--





Lumina Villa





Lumina Villa





Lumina Villa





Lumina Villa





Lumina Villa





Lumina Villa





Lumina Villa





Lumina Villa





Lumina Villa





Lumina Villa





Lumina Villa









Lumina Villa





Lumina Villa





Lumina Villa





Lumina Villa





Lumina Villa





Lumina Villa









Lumina Villa





Lumina Villa





Lumina Villa





Lumina Villa





Lumina Villa



2410 CREST VIEW DRIVE, LOS ANGELES

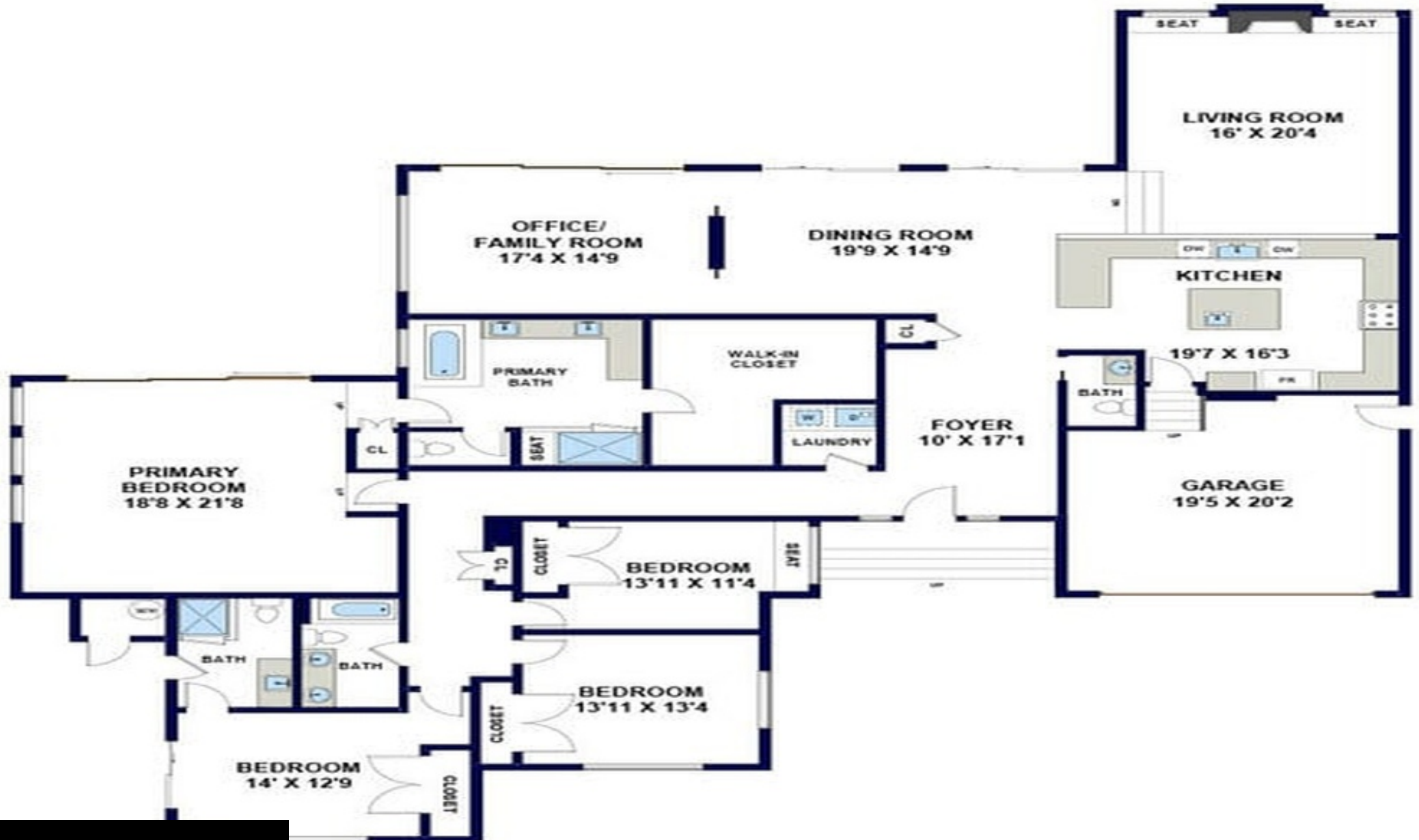





Lumina Villa





Lumina Villa





Lumina Villa





Lumina Villa





Lumina Villa





Lumina Villa





Lumina Villa





Lumina Villa





Lumina Villa





Lumina Villa





Lumina Villa





Lumina Villa





Lumina Villa





Lumina Villa









Lumina Villa





Lumina Villa





Lumina Villa





Lumina Villa





Lumina Villa





Lumina Villa





Lumina Villa





Lumina Villa





Lumina Villa



